

SPARKLZ

BY **DANUBE**

FLOOR PLANS





FLEX STUDIO-A

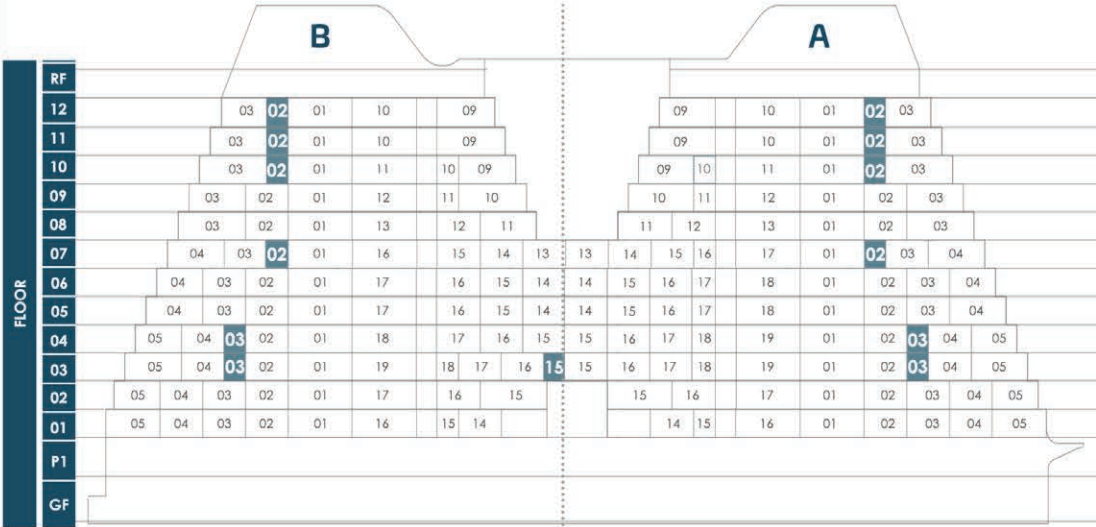

CITY SKYLINE VIEW

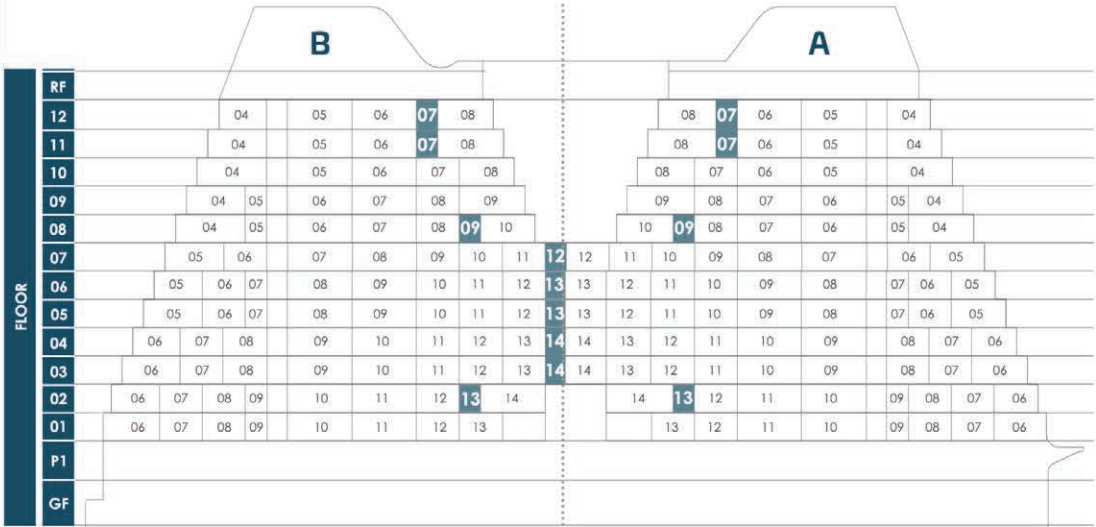

GARDENS VIEW

AREA (Sq.Ft)

Apartment
348 to 350
Balcony
60 to 61
Total
408 to 410

FEATURES:

☒ Convertible 1BHK



FLEX STUDIO-B

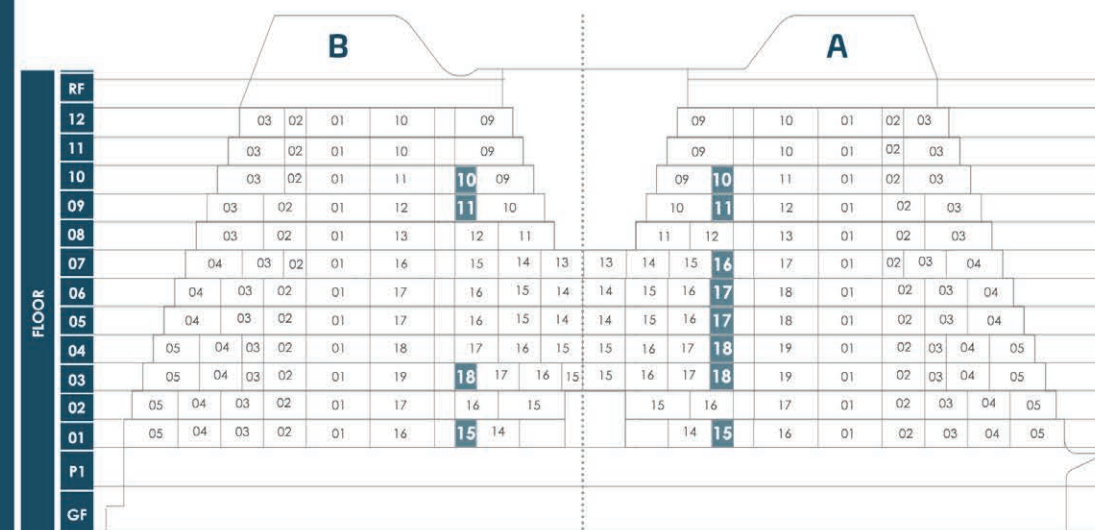

CITY SKYLINE VIEW

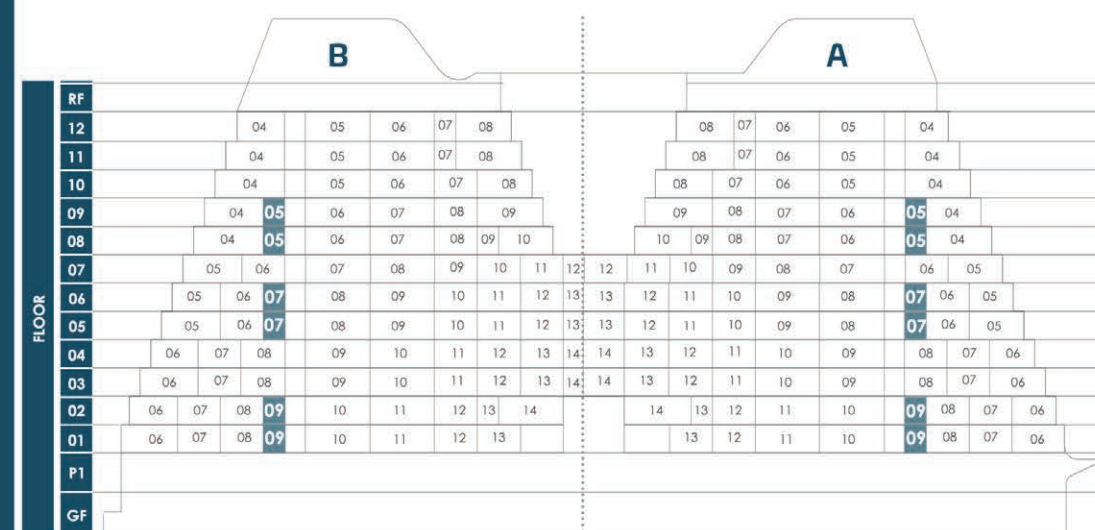

GARDENS VIEW

AREA (Sq.Ft)

Apartment
354

Balcony
130 to 132

Total
484 to 486

FEATURES:

☒ **Convertible 1BHK**



FLEX 1 BEDROOM-A

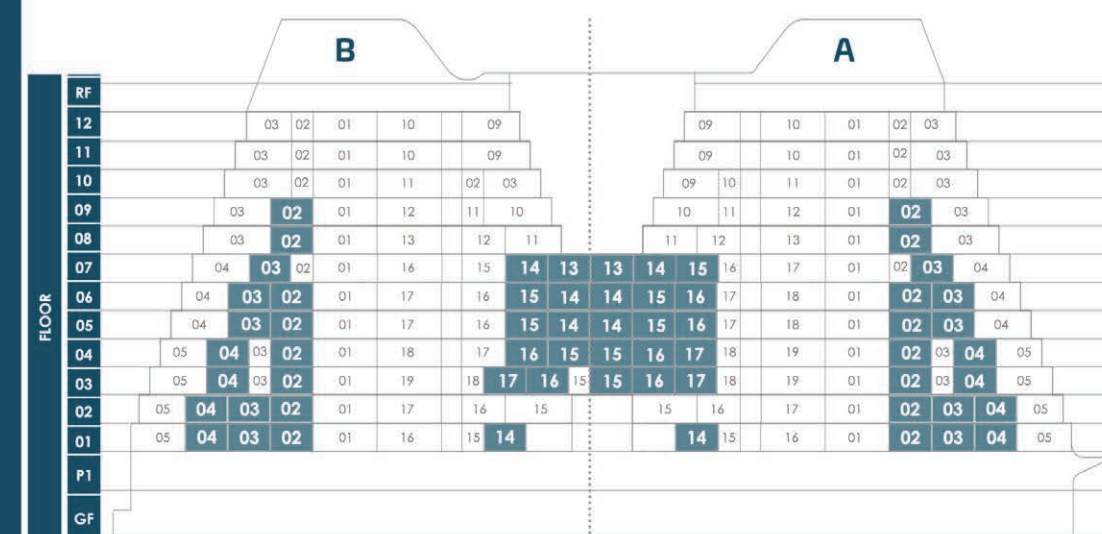

CITY SKYLINE VIEW

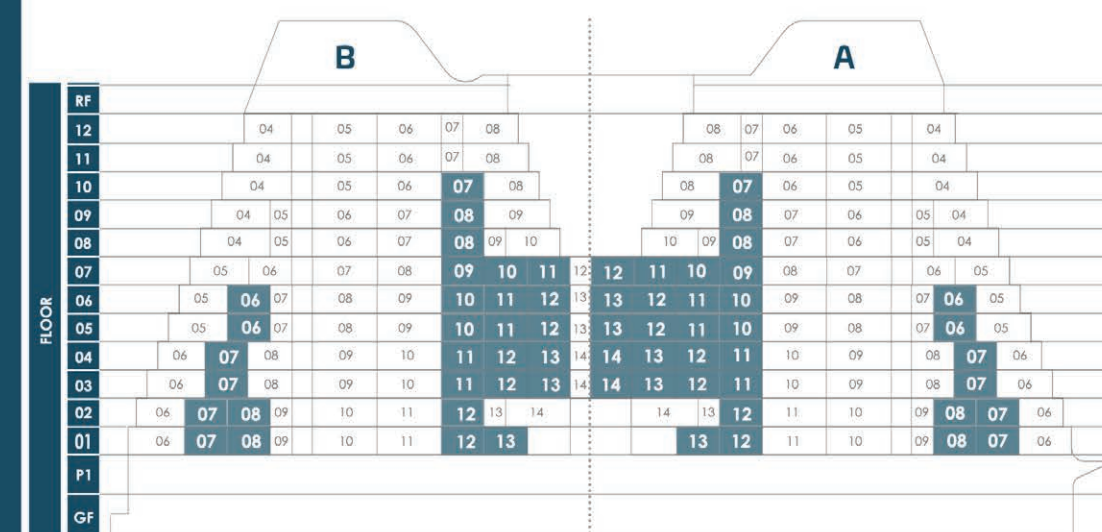

GARDENS VIEW

AREA (Sq.Ft)

Apartment
696 to 708

Balcony
120 to 122

Total
816 to 829

FEATURES:

- ☒ Convertible 2BHK
- ☒ Maid Room (w) Bath
- ☒ Office



FLEX 1 BEDROOM-B

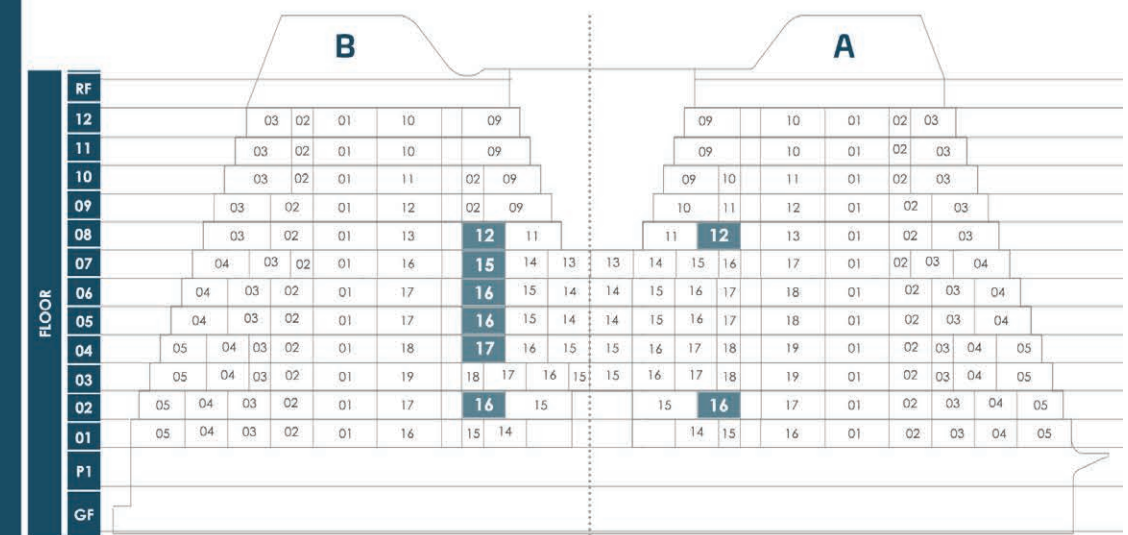

CITY SKYLINE VIEW

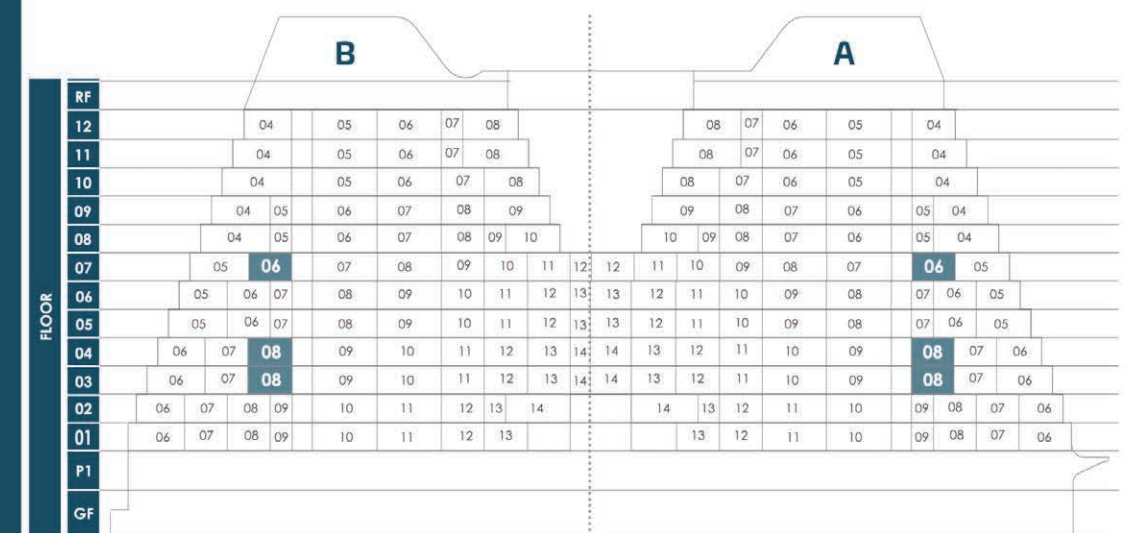

GARDENS VIEW

AREA (Sq.Ft)

Apartment
701 to 703

Balcony
191

Total
892 to 894

FEATURES:

- ☒ Convertible 2BHK
- ☒ Maid Room (w) Bath
- ☒ Office



2 BEDROOM-A

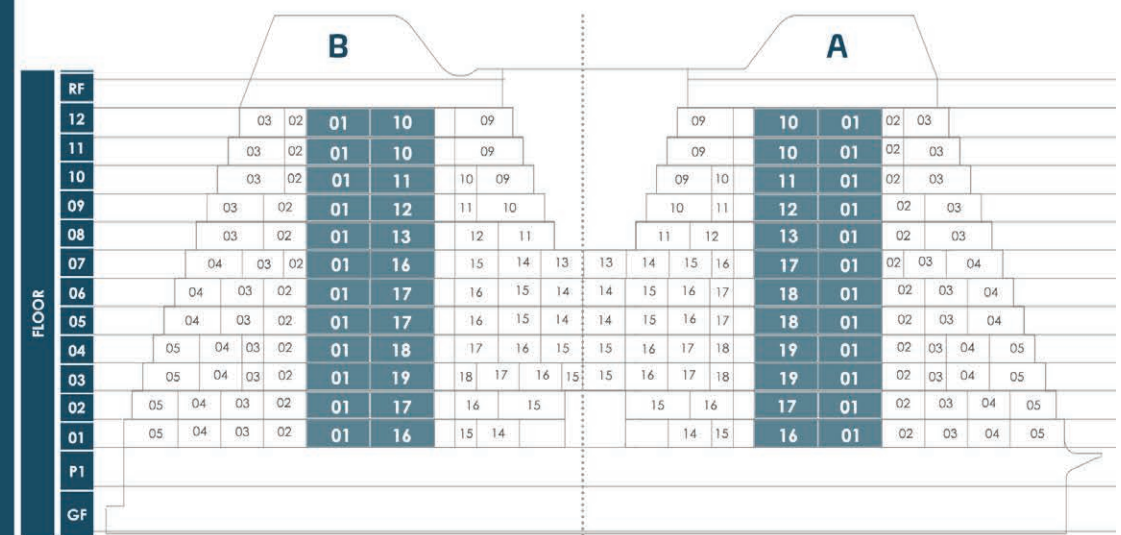

CITY SKYLINE VIEW

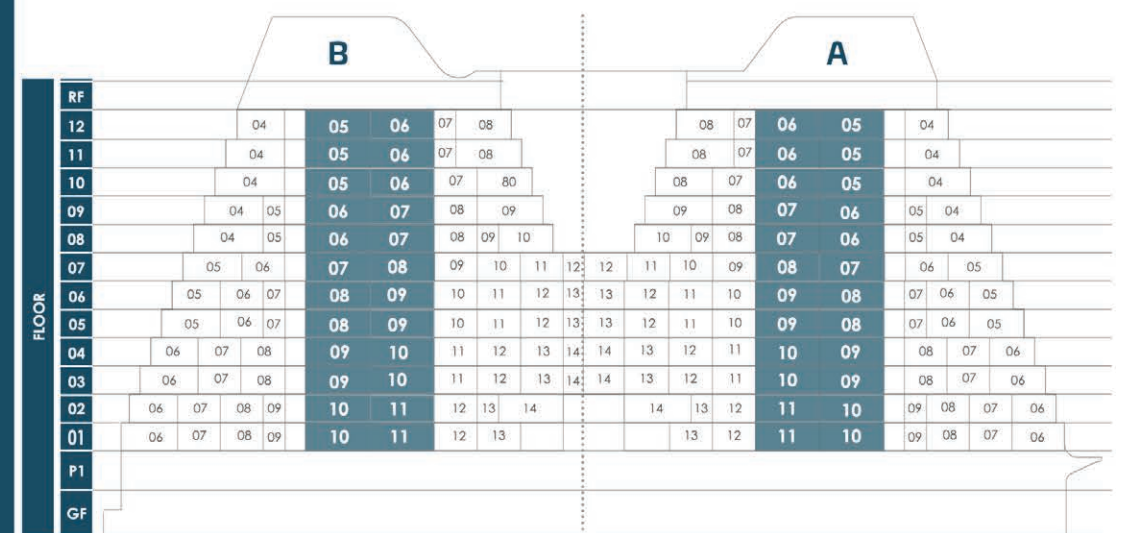

GARDENS VIEW

AREA (Sq.Ft)

Apartment
891 to 908

Balcony
180 to 183

Total
1,072 to 1,091

FEATURES:

☒ **Maid Room**



2 BEDROOM-B

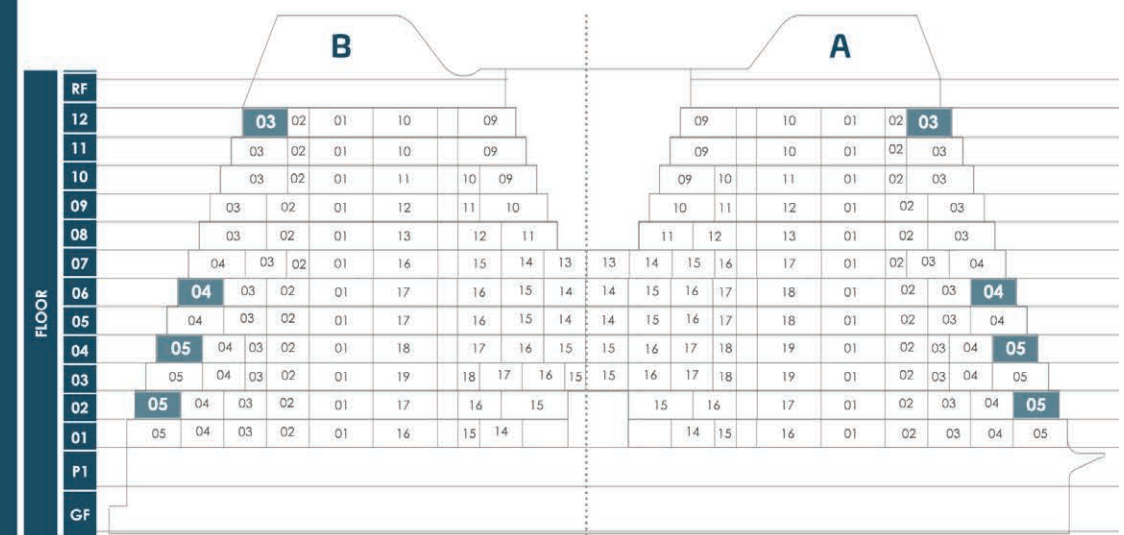

CITY SKYLINE VIEW

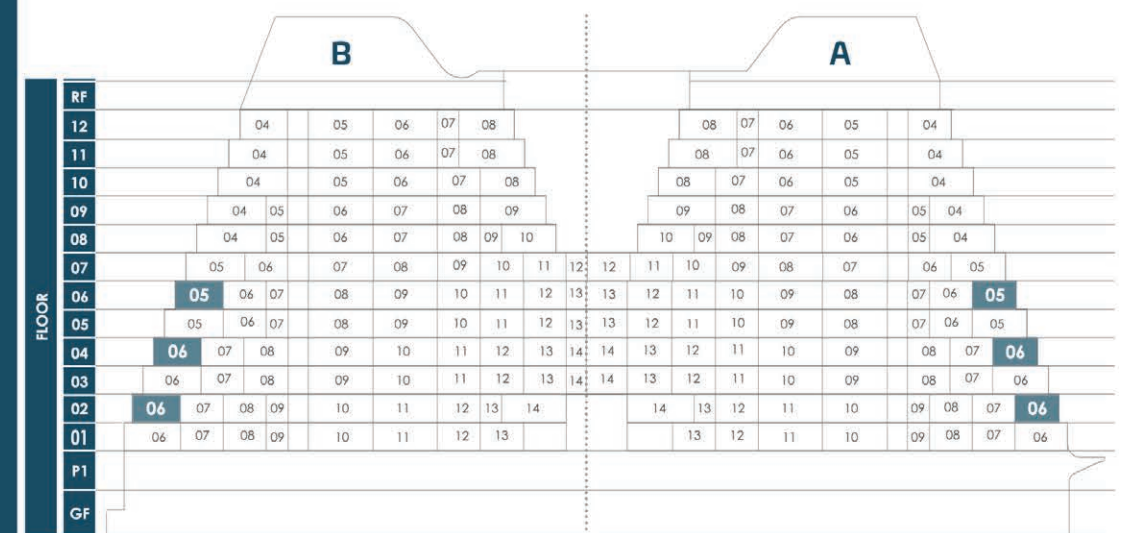

GARDENS VIEW

AREA (Sq.Ft)

Apartment
794 to 801

Balcony
339 to 345

Total
1,137 to 1,144



3 BEDROOM-A

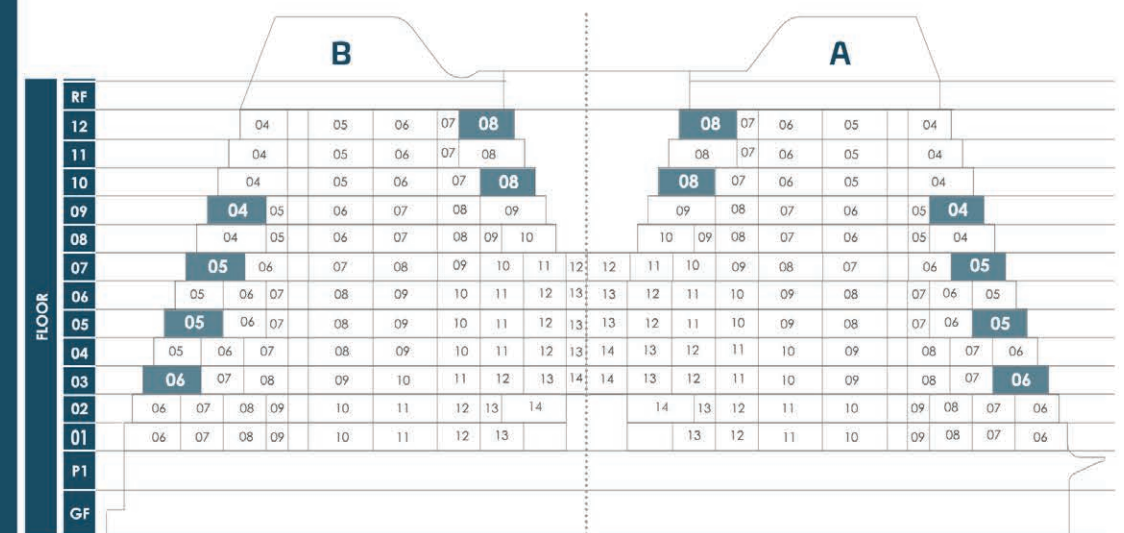
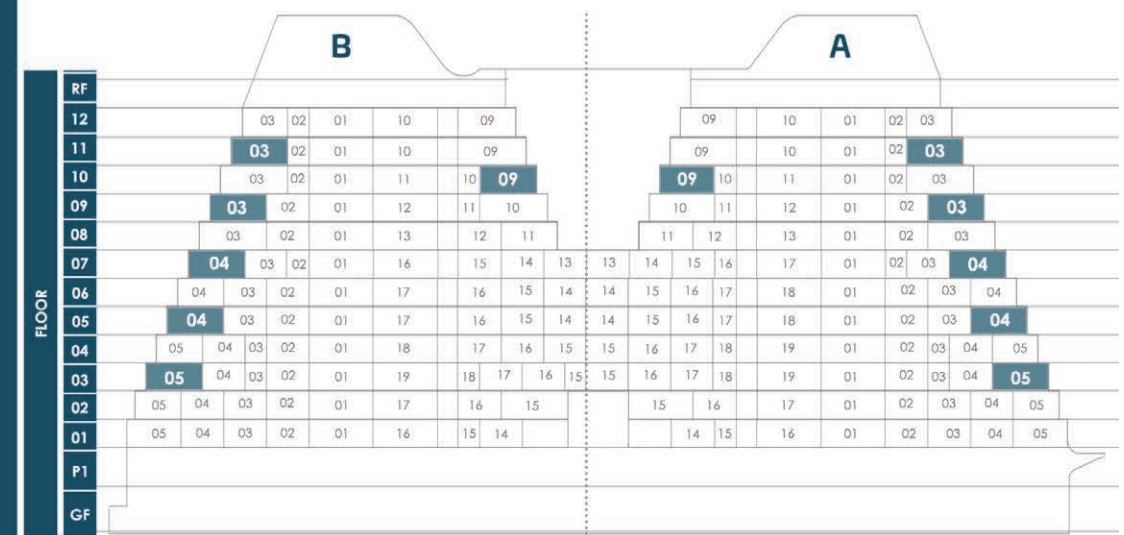

AREA (Sq.Ft)

Apartment
1,013 to 1,016

Balcony
365

Total
1,378 to 1,381

3 BEDROOM-B

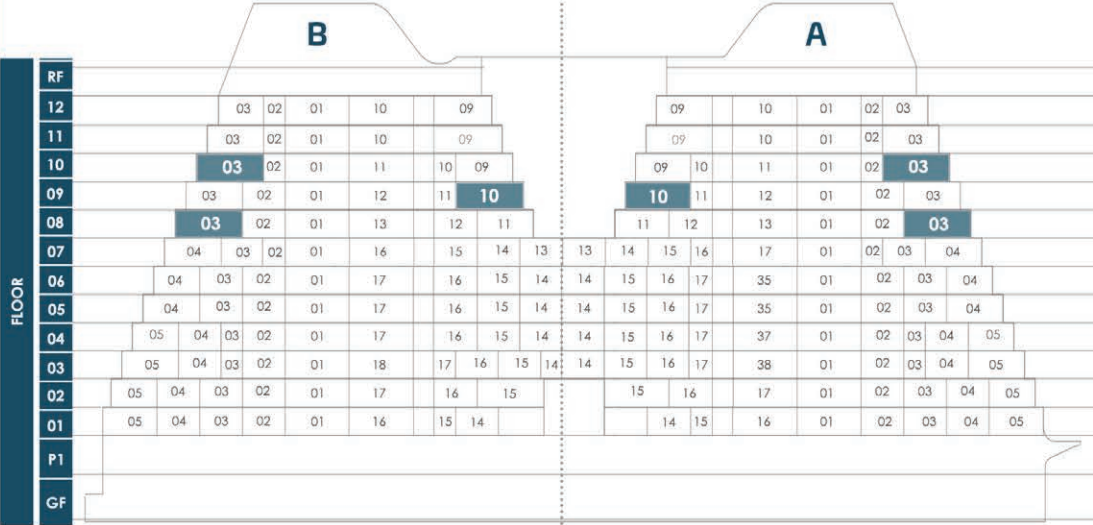

CITY SKYLINE VIEW

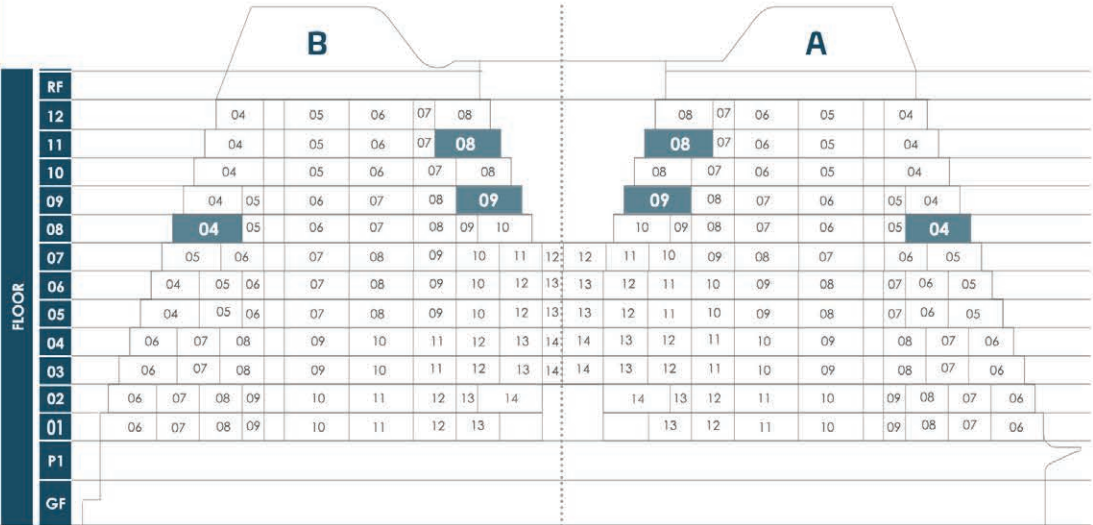

GARDENS VIEW

AREA (Sq.Ft)

Apartment
1,221 to 1,224

Balcony
381 to 383

Total
1,603 to 1,606

FEATURES:

- ☒ Maid Room
- ☒ Store

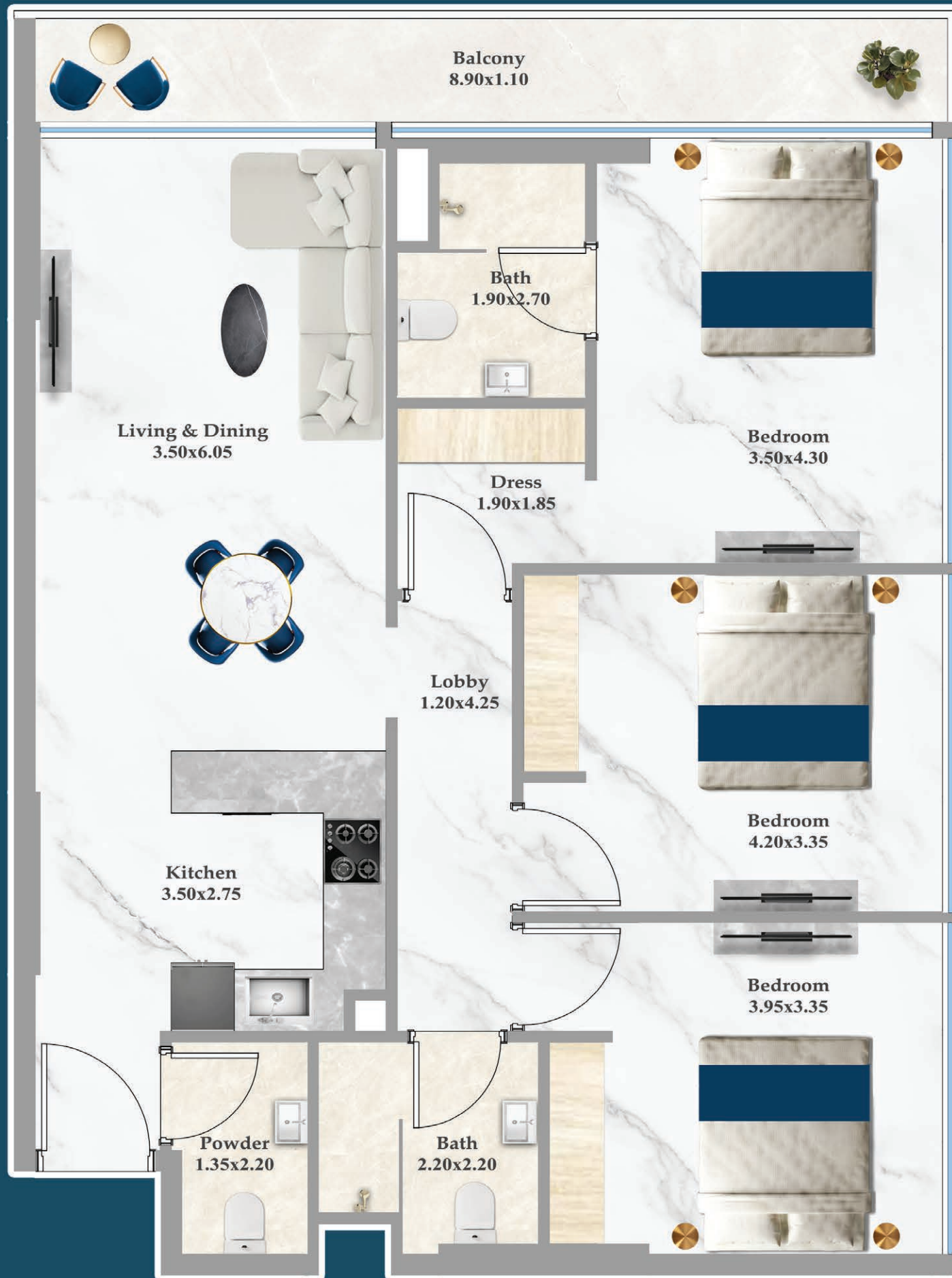

3 BEDROOM-C

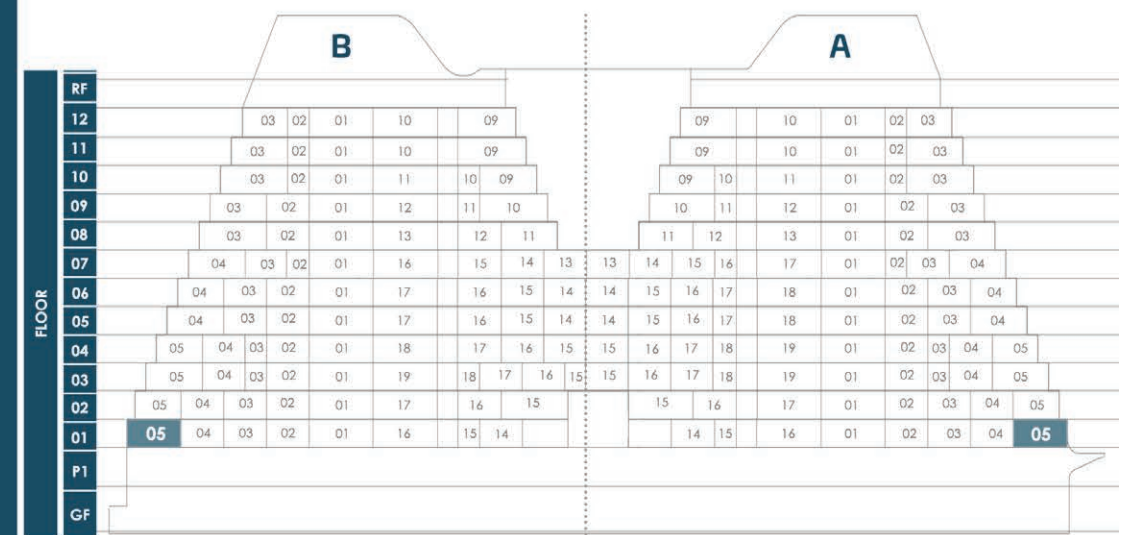

CITY SKYLINE VIEW

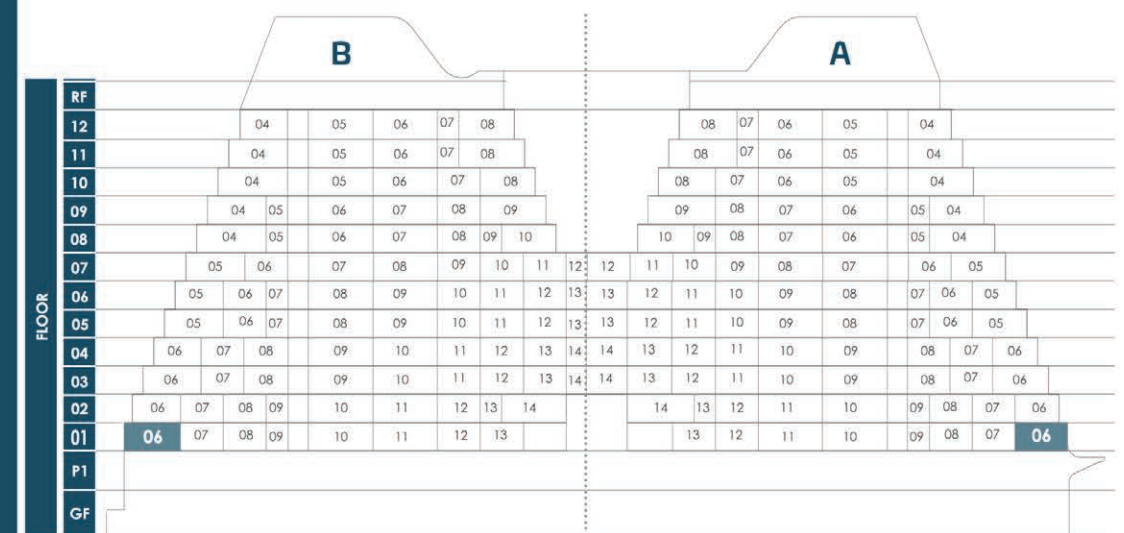

GARDENS VIEW

AREA (Sq.Ft)

Apartment
1,012 to 1,013

Balcony
112

Total
1,124 to 1,125

3 BEDROOM-D

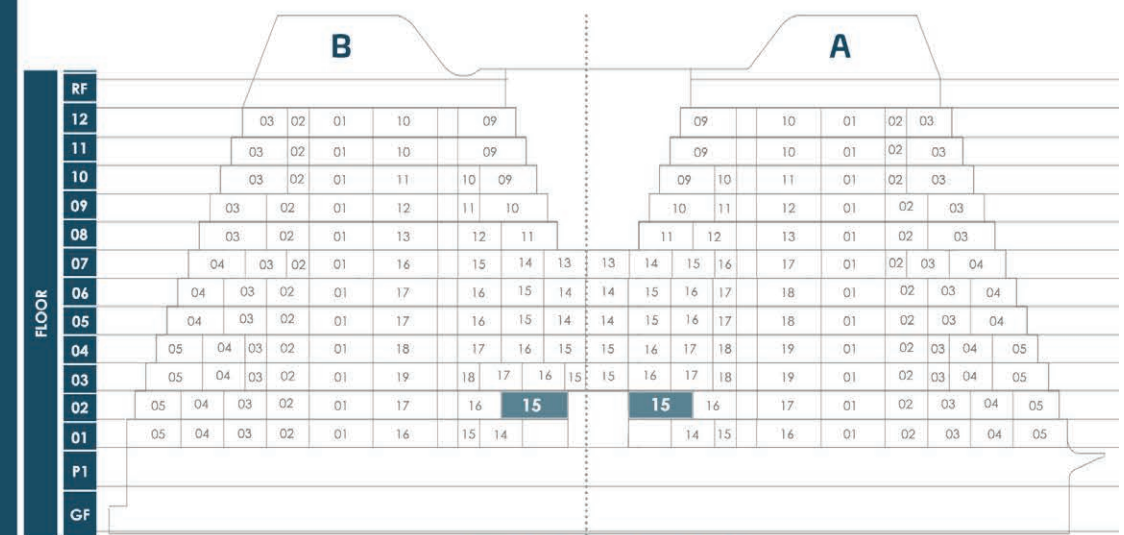

CITY SKYLINE VIEW

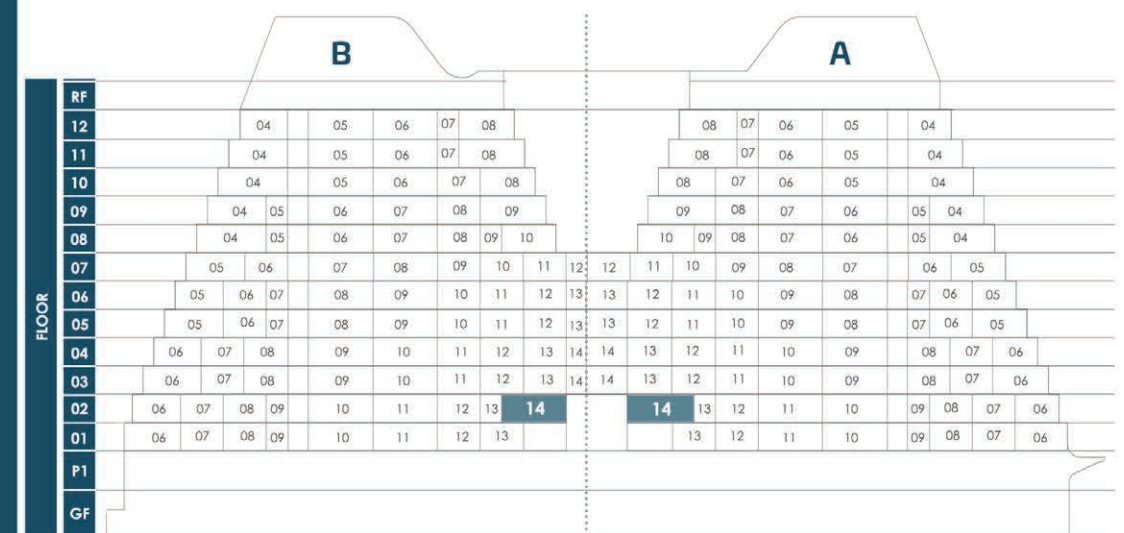

GARDENS VIEW

AREA (Sq.Ft)

Apartment

1,225

Balcony

122

Total

1,347

FEATURES:

☒ Maid Room (w) Bath

☒ Store

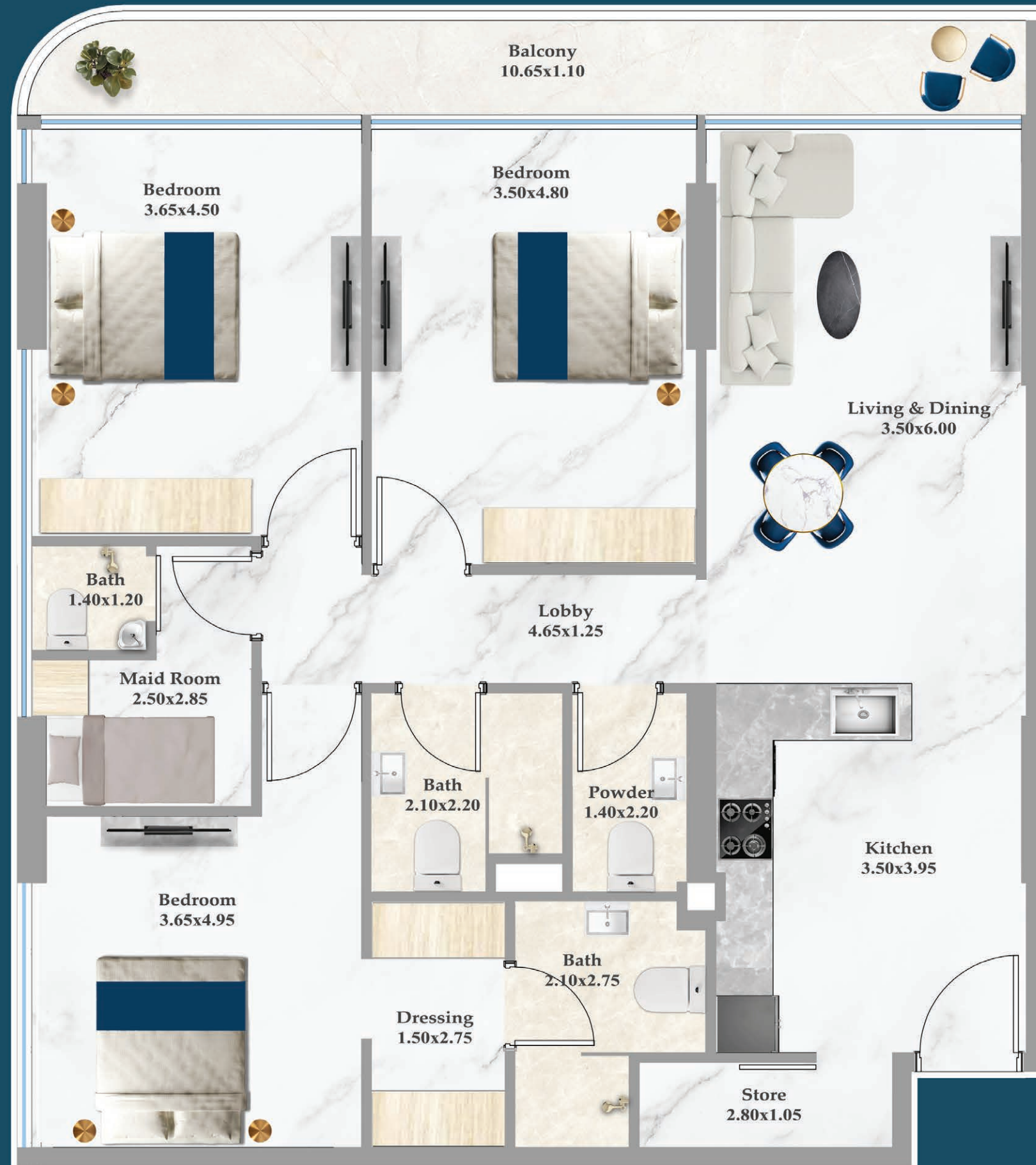



CITY SKYLINE VIEW

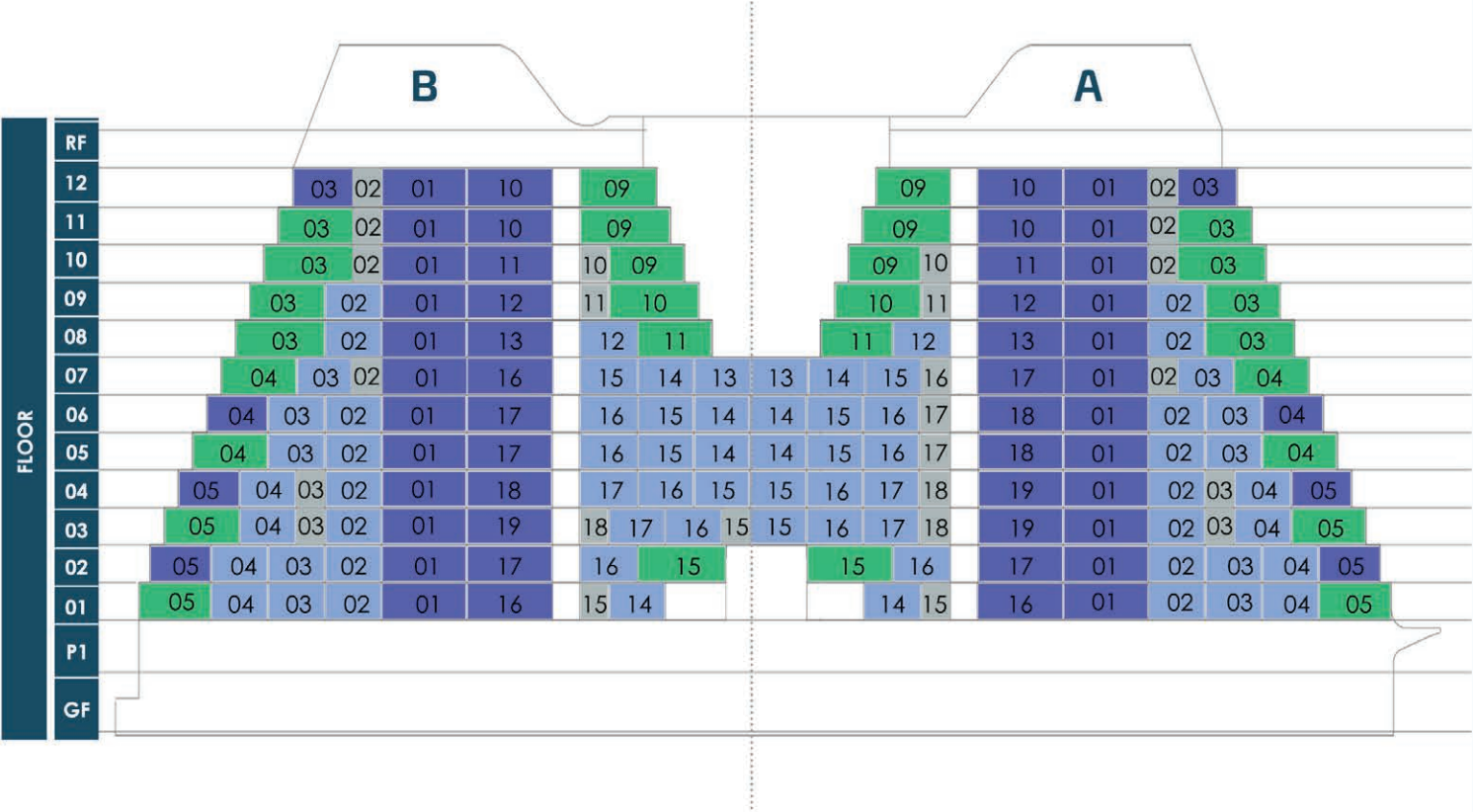

GARDENS VIEW

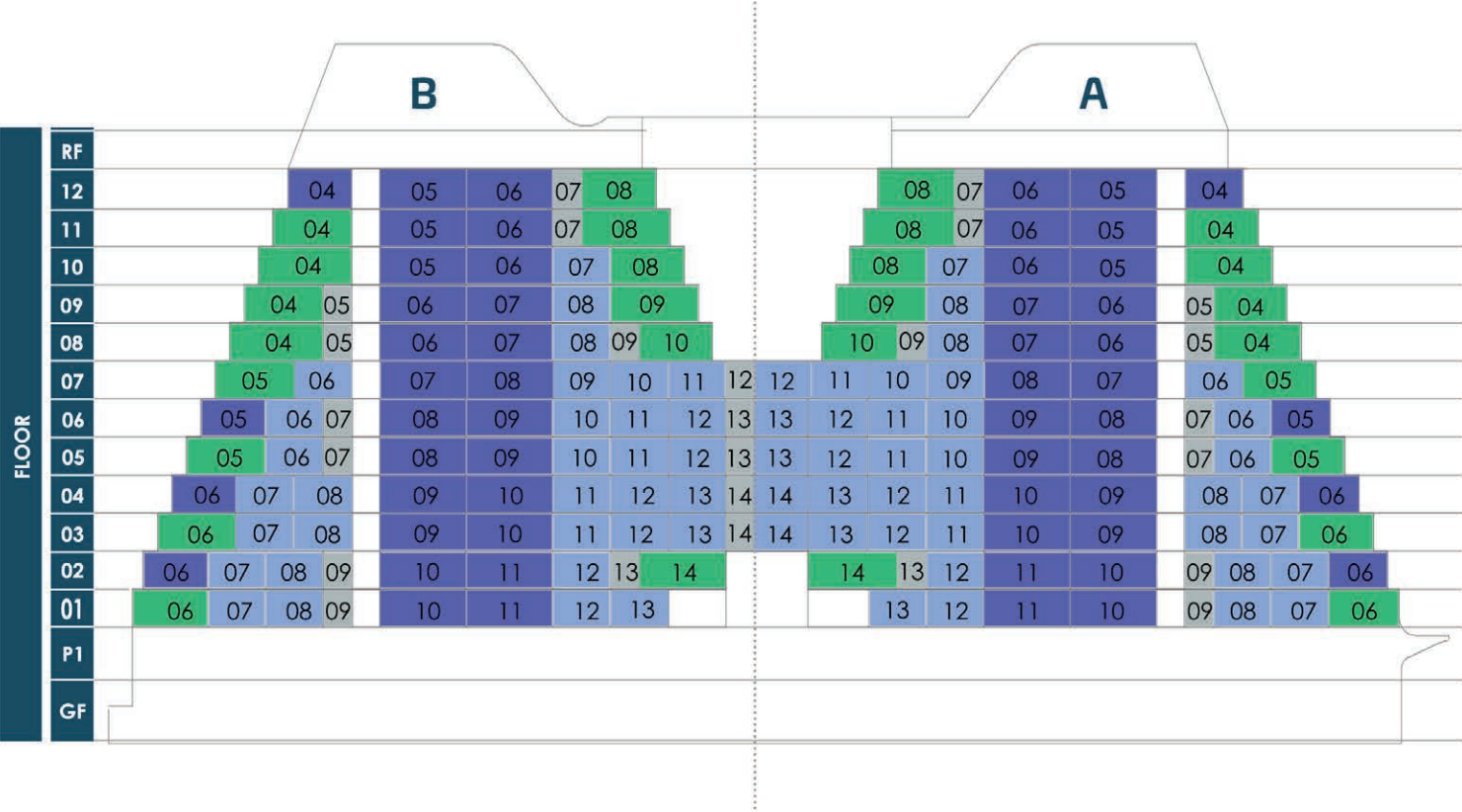

- STUDIO
- 1 BEDROOM
- 2 BEDROOMS
- 3 BEDROOMS

GARDENS VIEW

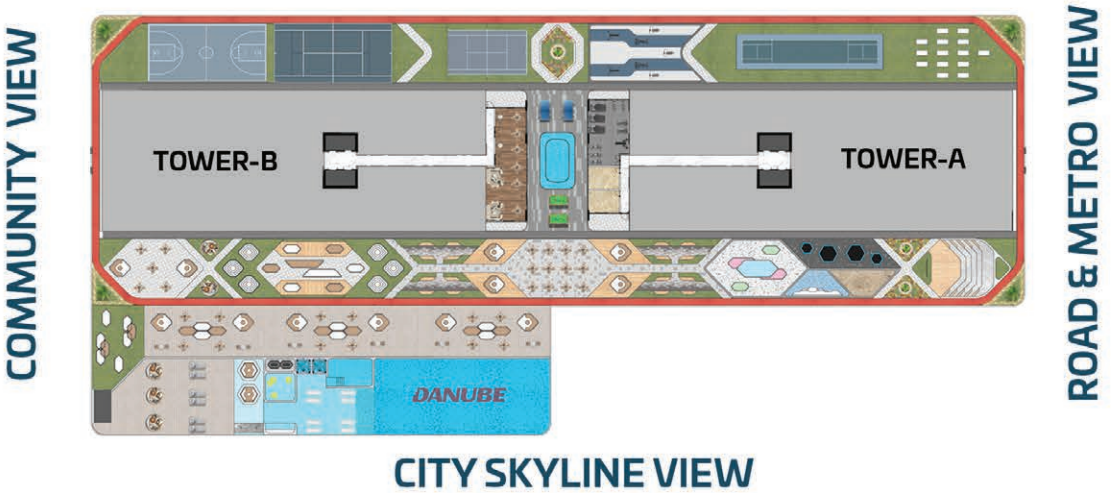



SPARKLZ AMENITIES

- | | | |
|-----------------------------|----------------------------|---------------------|
| 5. Infinity Pool | 20. Zumba Dance | 35. Badminton Court |
| 6. Shallow Pool | 21. Sparklz Photo Booth | 36. Paddle Court |
| 7. Jacuzzi | 22. Open Air Cinema | 37. Basketball |
| 8. Foot Bath | 23. Outdoor Party Area | 38. Mini Golf |
| 9. Aquatic Gym | 24. Indoor Party Area | 39. Changing Room |
| 10. Kids Pool | 25. Spa & Therapy | |
| 11. Splash Pad | 26. Kids Daycare | |
| 12. Floating Cabana | 27. Kids Play Area | |
| 13. Pool Deck | 28. Joggers' Arena | |
| 14. Pool Party Zone | 29. Yoga Zone | |
| 15. Sparklz Garden | 30. Cricket Pitch | |
| 16. Cabana & Family Seating | 31. Football Court | |
| 17. BBQ Zone | 32. Outdoor Gym | |
| 18. Health Bar | 33. Indoor Gym | |
| 19. Reflexology Path | 34. Snooker & Table Tennis | |



N

FLOOR 1 AMENITIES

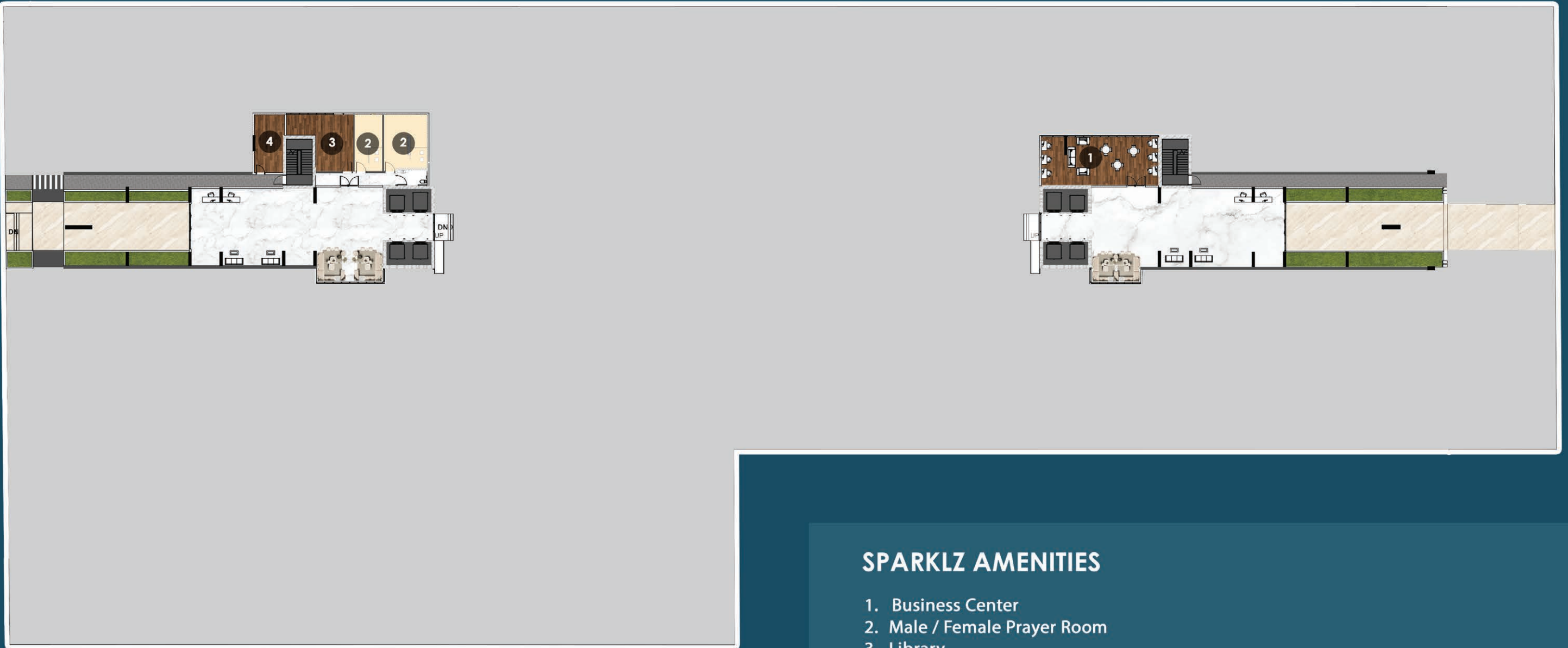

SPARKLZ AMENITIES

1. Business Center
2. Male / Female Prayer Room
3. Library
4. Beauty Salon



GROUND FLOOR AMENITIES



1. All Information, materials, plans and amenities are approximate and provided for illustrative purposes only. The Developer reserves the right to make revisions to the floor plans and any features, materials, dimensions, drawings, and amenities of the project without notice.
2. Units areas, actual dimensions, layout, location, specifications of balcony, door, wardrobe or other fixtures may vary floor to floor and between units and are subject to revision by the Developer.
3. Furniture and electric devices will not be provided by the Developer, unless specified otherwise in the Unit Sale Purchase Agreement.
4. The circulation area dimensions may be added to the nearby rooms & or the spaces dimensions for illustration purpose.