



Parkland

DUBAI HILLS ESTATE

DUBAI HILLS ESTATE

Dubai Hills Estate – the green heart of Dubai – is a first-of-its-kind destination. This masterfully planned, multi-purpose development forms an integral part of the Mohammed Bin Rashid City. Strategically situated between Downtown Dubai and Dubai Marina, flanked by Al Khail Road, the community offers easy access to the city’s most popular districts and attractions.

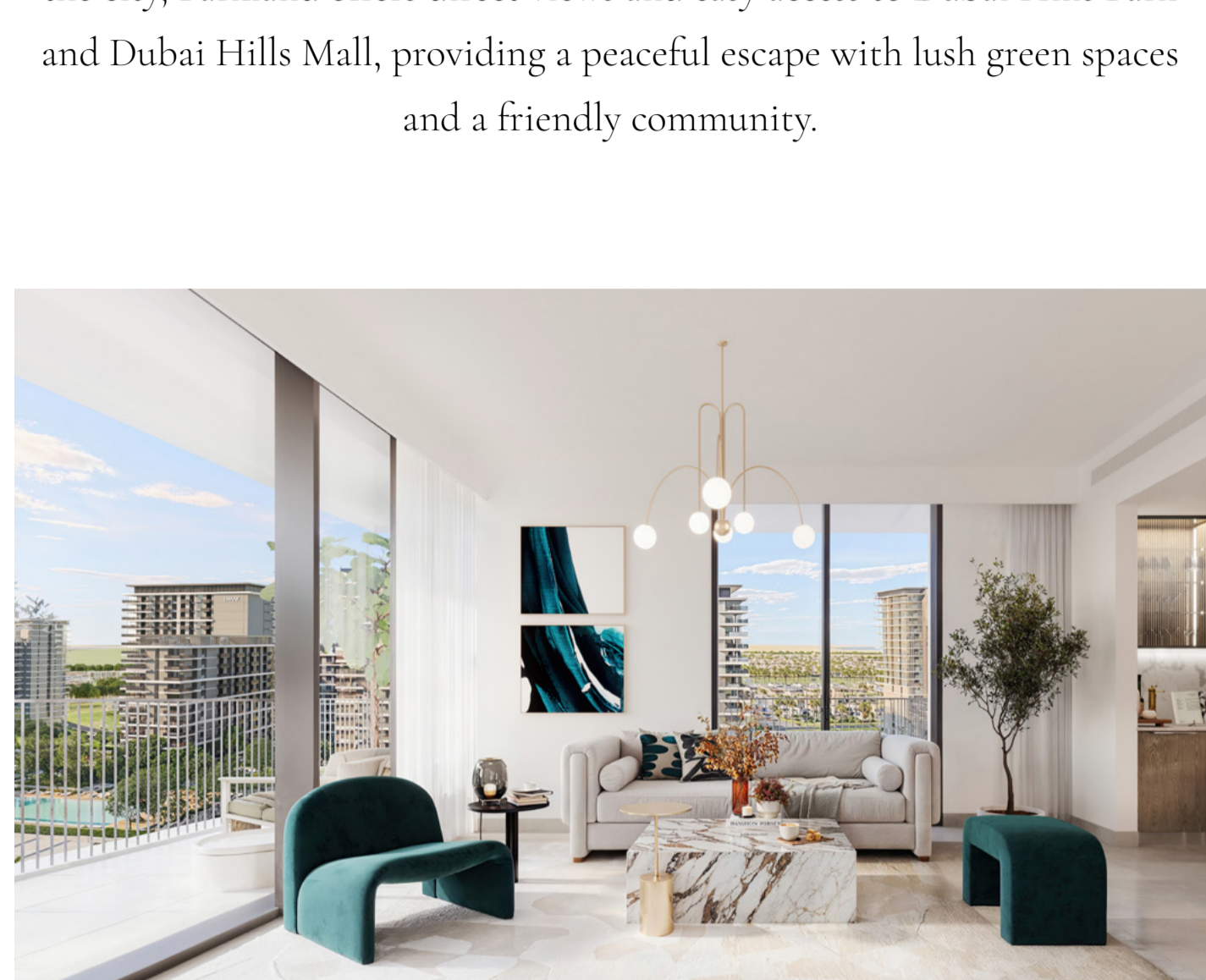

Urban Living Redefined by Nature’s Bliss

A unique blend of city life and natural beauty. Located in the heart of the city, Parkland offers direct views and easy access to Dubai Hills Park and Dubai Hills Mall, providing a peaceful escape with lush green spaces and a friendly community.

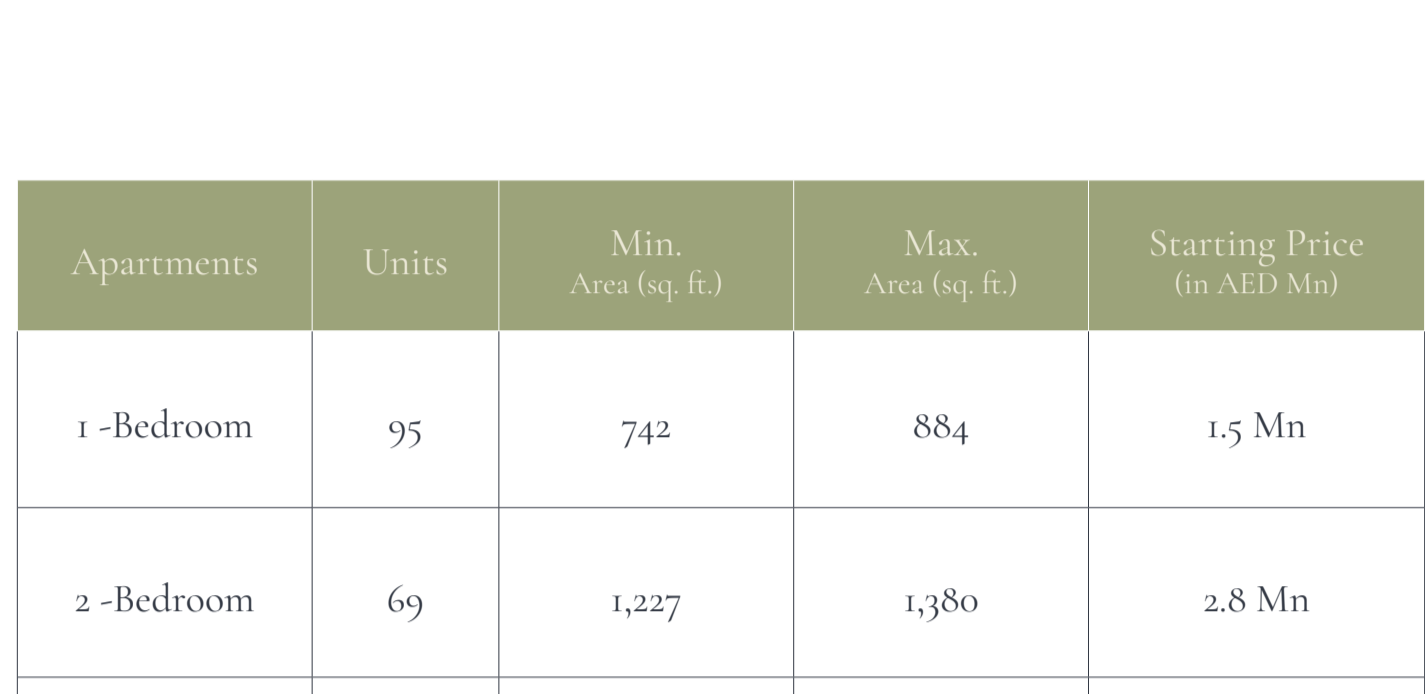

Crafted with elegance and passion, our residential offerings range from 1, 2 & 3-bedroom apartments.

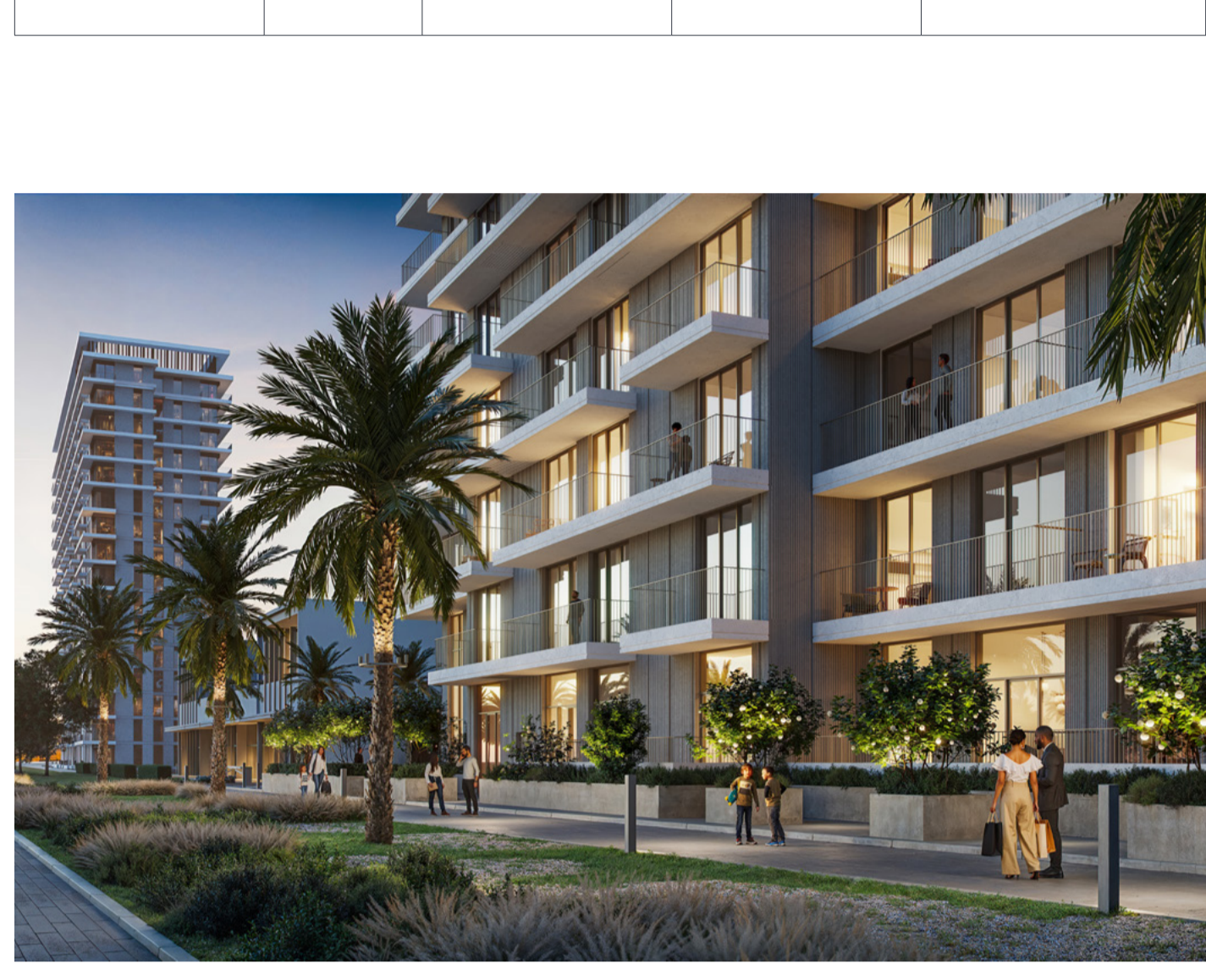

Apartments	Units	Min. Area (sq. ft.)	Max. Area (sq. ft.)	Starting Price (in AED Mn)
1-Bedroom	95	742	884	1.5 Mn
2-Bedroom	69	1,227	1,380	2.8 Mn
3-Bedroom	45	1,813	1,841	4 Mn



Instalment	Payment Percentage	Date
Down Payment	10%	AUG 2024
1st Instalment	10%	OCT 2024
2nd Instalment	10%	MAR 2025
3rd Instalment	10%	AUG 2025
4th Instalment 20% Construction Completion	10%	APR 2026
5th Instalment 40% Construction Completion	10%	DEC 2026
6th Instalment 50% Construction Completion	5%	MAR 2027
7th Instalment 70% Construction Completion	10%	SEP 2027
8th Instalment 80% Construction Completion	5%	JAN 2028
9th Instalment 100% Construction Completion	20%	NOV 2028



Elevated Amenities Just for You

- Gym (Indoor & Outdoor)
- Swimming Pool (Adults & Kids)
- Play Area
- Communal Spaces
- BBQ Area
- Padel Tennis Court

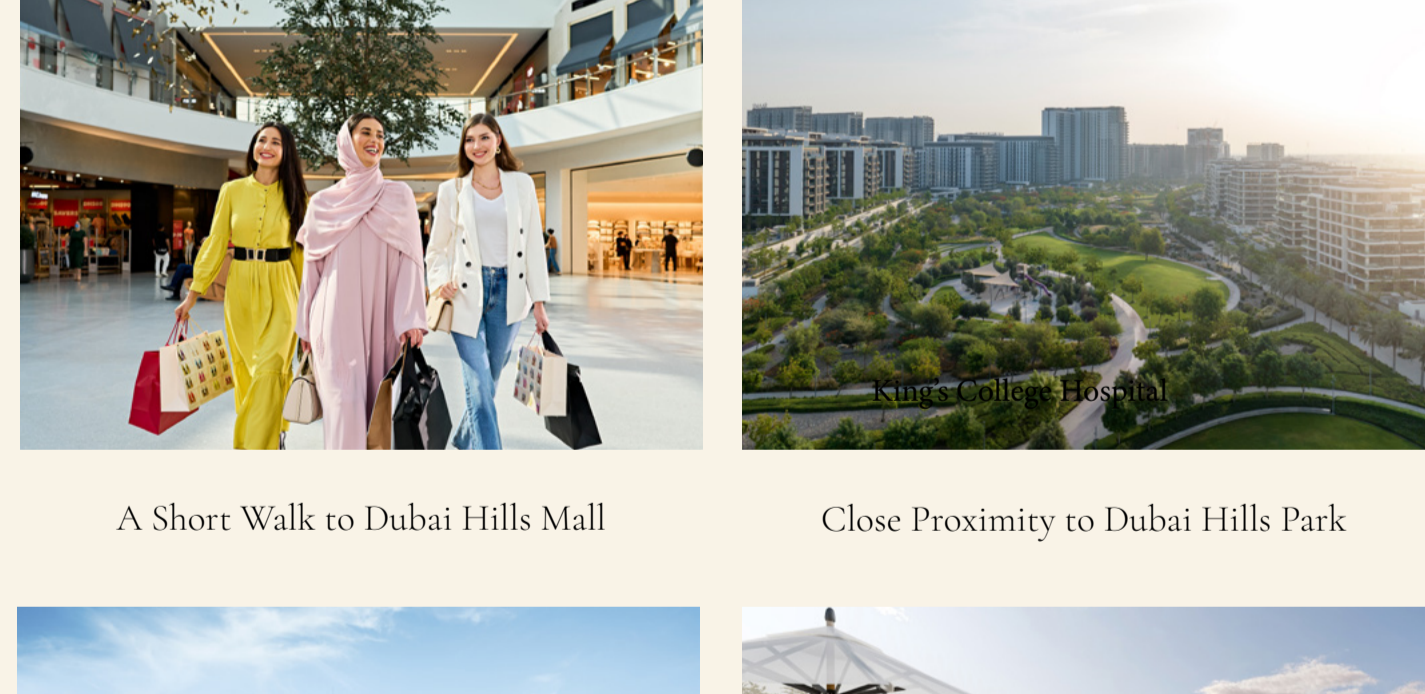
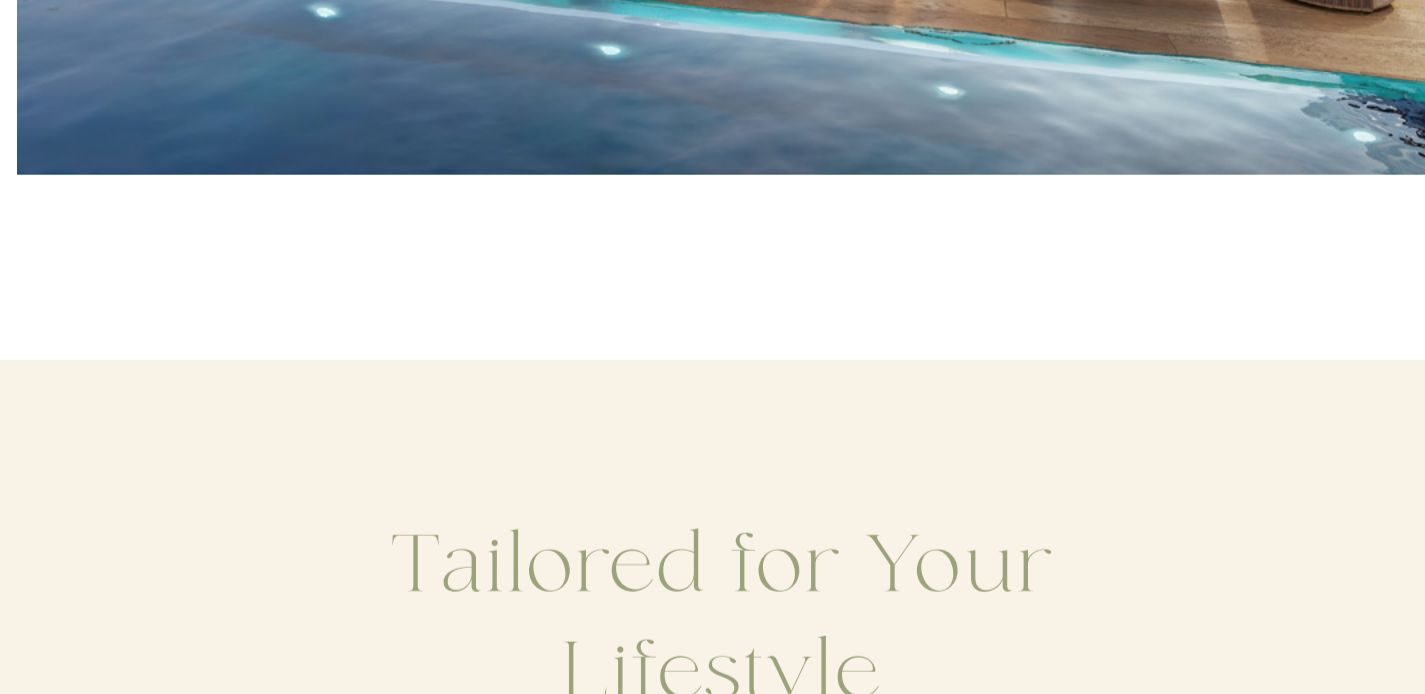
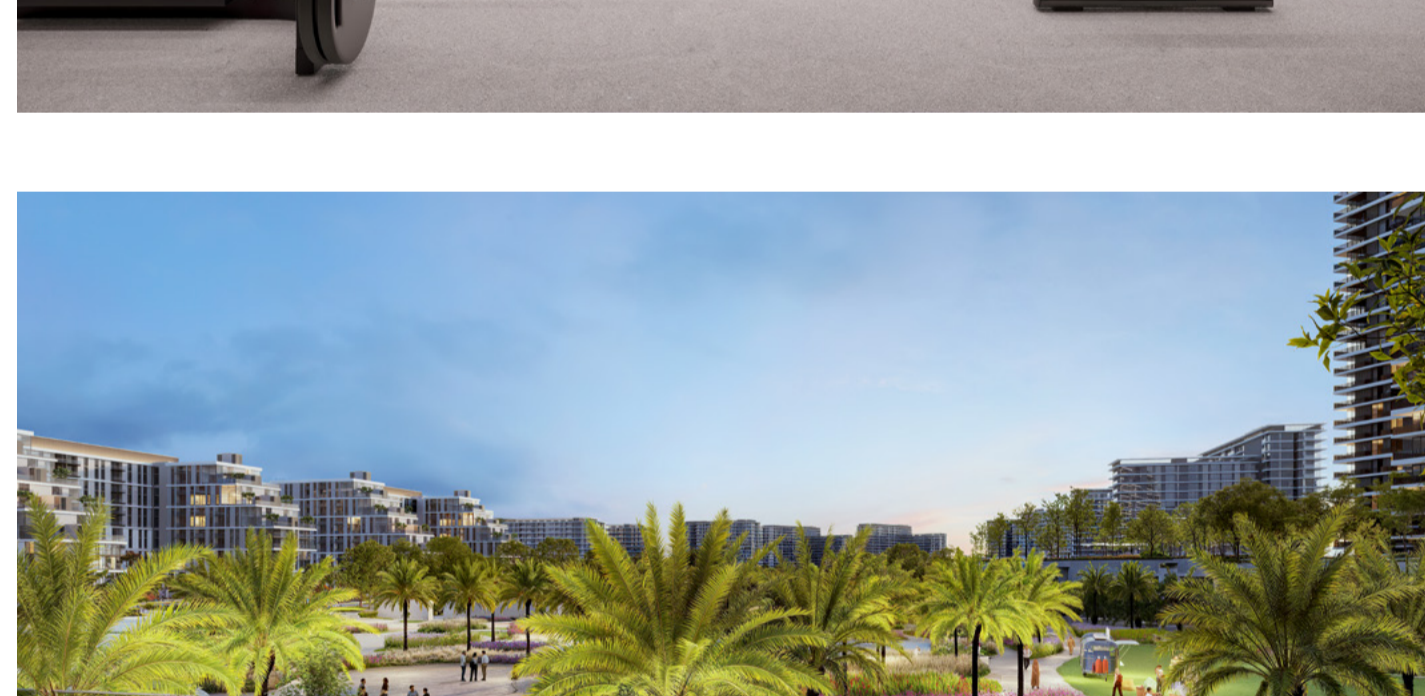

Tailored for Your Lifestyle

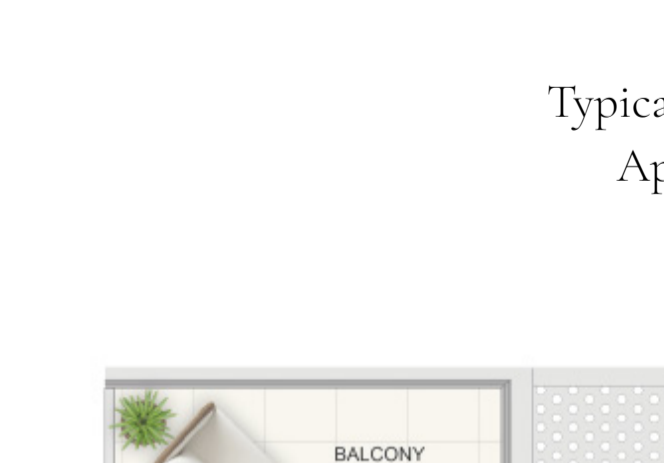

A Short Walk to Dubai Hills Mall

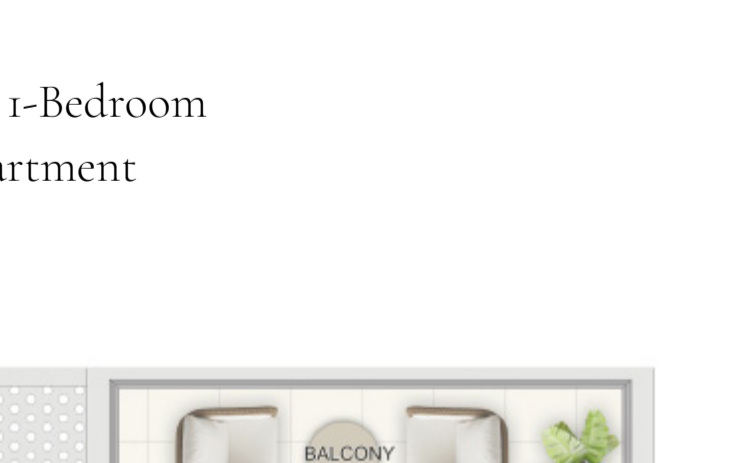

Close Proximity to Dubai Hills Park

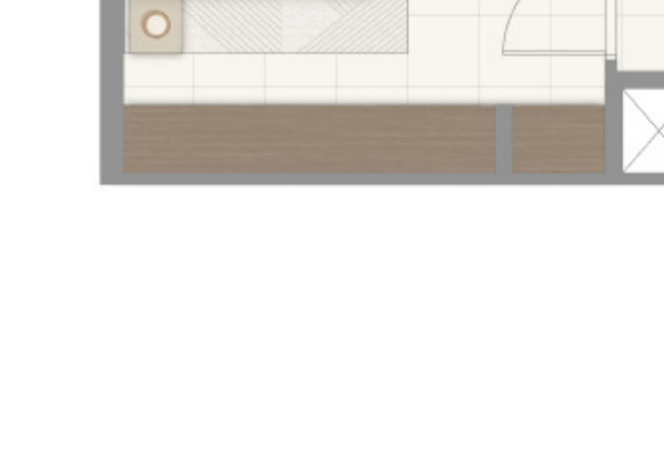

Dubai Hills Golf Club



Swimming Pool & Kids' Pool

Floor Plans

Typical 1-Bedroom Apartment



Typical 2-Bedroom Apartment



Typical 3-Bedroom Apartment

