

PARK LANE

DUBAI HILLS ESTATE

— INTERIORS BY VIDA —

FLOOR PLAN - BUILDING 3A

EMAAR

PARK LANE

DUBAI HILLS ESTATE

— INTERIORS BY VIDA —

1 BEDROOM

TYPE 1 | BUILDING 03A

UNITS 105, 205, 305, 405, 505, 605, 705, 805, 905

| | | |
|--------------|-------------|-----------|
| SUITE AREA | 586.2 SQFT | 54.46 SQM |
| BALCONY AREA | 63.29 SQFT | 5.88 SQM |
| TOTAL AREA | 649.49 SQFT | 60.34 SQM |

UNITS 107, 201, 301, 401, 501, 601, 701, 801, 901

| | | |
|--------------|-------------|----------|
| SUITE AREA | 586.63 SQFT | 54.5 SQM |
| BALCONY AREA | 64.58 SQFT | 6 SQM |
| TOTAL AREA | 651.22 SQFT | 60.5 SQM |



KEY SECTION



BUILDING 03A

KEY PLAN

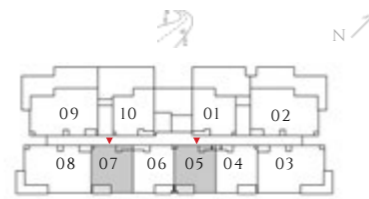

LEVEL 01

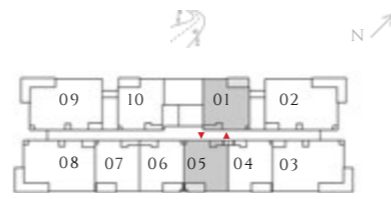

LEVEL 02-09

FLOOR PLAN 1. All dimensions are in imperial and metric, and measured from finish to finish excluding construction tolerances. 2. All materials, dimensions, and drawings are approximate only. 3. Information is subject to change without notice, at developer's absolute discretion. 4. Actual area may vary from the stated area. 5. Drawings not to scale. 6. All images used are for illustrative purposes only and do not represent the actual size, features, specifications, fittings, and furnishings. 7. The developer reserves the right to make revisions / alterations, at it's absolute discretion, without any liability whatsoever.

PARK LANE

DUBAI HILLS ESTATE

— INTERIORS BY VIDA —

1 BEDROOM

TYPE 1 | BUILDING 03A

UNITS 207, 307, 407, 507, 607, 707, 807, 907

| | | |
|--------------|-------------|-----------|
| SUITE AREA | 586.2 SQFT | 54.46 SQM |
| BALCONY AREA | 64.58 SQFT | 6 SQM |
| TOTAL AREA | 650.79 SQFT | 60.46 SQM |



KEY SECTION



BUILDING 03A

KEY PLAN



LEVEL 02-09

FLOOR PLAN 1. All dimensions are in imperial and metric, and measured from finish to finish excluding construction tolerances. 2. All materials, dimensions, and drawings are approximate only. 3. Information is subject to change without notice, at developer's absolute discretion. 4. Actual area may vary from the stated area. 5. Drawings not to scale. 6. All images used are for illustrative purposes only and do not represent the actual size, features, specifications, fittings, and furnishings. 7. The developer reserves the right to make revisions / alterations, at it's absolute discretion, without any liability whatsoever.

PARK LANE

DUBAI HILLS ESTATE

— INTERIORS BY VIDA —

1 BEDROOM

TYPE 1 MIRROR | BUILDING 03A

UNITS 104

| | | |
|--------------|-------------|----------|
| SUITE AREA | 586.63 SQFT | 54.5 SQM |
| BALCONY AREA | 64.58 SQFT | 6 SQM |
| TOTAL AREA | 651.22 SQFT | 60.5 SQM |

UNITS 106, 206, 306, 406, 506, 606, 706, 806, 906

| | | |
|--------------|-------------|-----------|
| SUITE AREA | 586.2 SQFT | 54.46 SQM |
| BALCONY AREA | 63.29 SQFT | 5.88 SQM |
| TOTAL AREA | 649.49 SQFT | 60.34 SQM |



KEY SECTION



BUILDING 03A

KEY PLAN

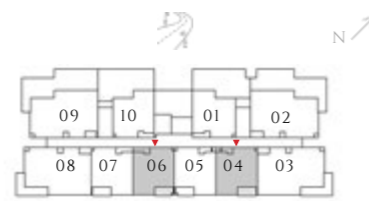

LEVEL 01



LEVEL 02-09

FLOOR PLAN 1. All dimensions are in imperial and metric, and measured from finish to finish excluding construction tolerances. 2. All materials, dimensions, and drawings are approximate only. 3. Information is subject to change without notice, at developer's absolute discretion. 4. Actual area may vary from the stated area. 5. Drawings not to scale. 6. All images used are for illustrative purposes only and do not represent the actual size, features, specifications, fittings, and furnishings. 7. The developer reserves the right to make revisions / alterations, at it's absolute discretion, without any liability whatsoever.

PARK LANE

DUBAI HILLS ESTATE

— INTERIORS BY VIDA —

1 BEDROOM

TYPE 1 MIRROR | BUILDING 03A

UNITS 204, 304, 404, 504, 604, 704, 804, 904

| | | |
|--------------|-------------|-----------|
| SUITE AREA | 586.2 SQFT | 54.46 SQM |
| BALCONY AREA | 64.58 SQFT | 6 SQM |
| TOTAL AREA | 650.79 SQFT | 60.46 SQM |

UNITS 210, 310, 410, 510, 610, 710, 810, 910

| | | |
|--------------|-------------|-----------|
| SUITE AREA | 586.53 SQFT | 54.49 SQM |
| BALCONY AREA | 65.77 SQFT | 6.11 SQM |
| TOTAL AREA | 652.29 SQFT | 60.6 SQM |



KEY SECTION



BUILDING 03A

KEY PLAN

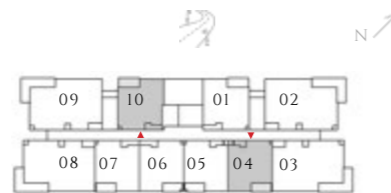

LEVEL 02-09

FLOOR PLAN 1. All dimensions are in imperial and metric, and measured from finish to finish excluding construction tolerances. 2. All materials, dimensions, and drawings are approximate only. 3. Information is subject to change without notice, at developer's absolute discretion. 4. Actual area may vary from the stated area. 5. Drawings not to scale. 6. All images used are for illustrative purposes only and do not represent the actual size, features, specifications, fittings, and furnishings. 7. The developer reserves the right to make revisions / alterations, at it's absolute discretion, without any liability whatsoever.

PARK LANE

DUBAI HILLS ESTATE

— INTERIORS BY VIDA —

1 BEDROOM

TYPE 1.2 | BUILDING 03A

UNITS 101

| | | |
|--------------|--------------|-----------|
| SUITE AREA | 585.66 SQFT | 54.41 SQM |
| BALCONY AREA | 496.11 SQFT | 46.09 SQM |
| TOTAL AREA | 1081.77 SQFT | 100.5 SQM |



KEY SECTION

KEY PLAN



BUILDING 03A

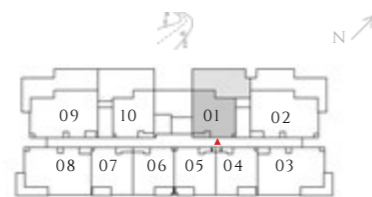

LEVEL 01

FLOOR PLAN 1. All dimensions are in imperial and metric, and measured from finish to finish excluding construction tolerances. 2. All materials, dimensions, and drawings are approximate only. 3. Information is subject to change without notice, at developer's absolute discretion. 4. Actual area may vary from the stated area. 5. Drawings not to scale. 6. All images used are for illustrative purposes only and do not represent the actual size, features, specifications, fittings, and furnishings. 7. The developer reserves the right to make revisions / alterations, at it's absolute discretion, without any liability whatsoever.

PARK LANE

DUBAI HILLS ESTATE

— INTERIORS BY VIDA —

1 BEDROOM

TYPE 1.2 MIRROR | BUILDING 03A

UNITS 110

| | | |
|--------------|--------------|------------|
| SUITE AREA | 586.53 SQFT | 54.49 SQM |
| BALCONY AREA | 490.08 SQFT | 45.53 SQM |
| TOTAL AREA | 1076.61 SQFT | 100.02 SQM |



KEY SECTION



BUILDING 03A

KEY PLAN

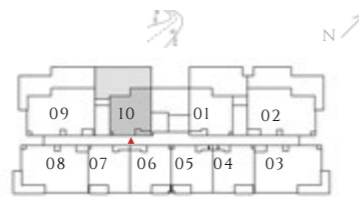

LEVEL 01

FLOOR PLAN 1. All dimensions are in imperial and metric, and measured from finish to finish excluding construction tolerances. 2. All materials, dimensions, and drawings are approximate only. 3. Information is subject to change without notice, at developer's absolute discretion. 4. Actual area may vary from the stated area. 5. Drawings not to scale. 6. All images used are for illustrative purposes only and do not represent the actual size, features, specifications, fittings, and furnishings. 7. The developer reserves the right to make revisions / alterations, at it's absolute discretion, without any liability whatsoever.

PARK LANE

DUBAI HILLS ESTATE

— INTERIORS BY VIDA —

2 BEDROOM

TYPE 1 | BUILDING 3A

UNITS 103, 203, 209, 303, 309, 403, 409, 503, 509, 603, 609, 703,
709, 803, 809, 903, 909

| | | |
|--------------|--------------|------------|
| SUITE AREA | 951.31 SQFT | 88.38 SQM |
| BALCONY AREA | 151.88 SQFT | 14.11 SQM |
| TOTAL AREA | 1103.19 SQFT | 102.49 SQM |



KEY SECTION



BUILDING 03A

KEY PLAN

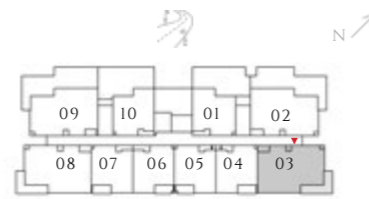

LEVEL 01



LEVEL 02-09

FLOOR PLAN 1. All dimensions are in imperial and metric, and measured from finish to finish excluding construction tolerances. 2. All materials, dimensions, and drawings are approximate only. 3. Information is subject to change without notice, at developer's absolute discretion. 4. Actual area may vary from the stated area. 5. Drawings not to scale. 6. All images used are for illustrative purposes only and do not represent the actual size, features, specifications, fittings, and furnishings. 7. The developer reserves the right to make revisions / alterations, at it's absolute discretion, without any liability whatsoever.

PARK LANE

DUBAI HILLS ESTATE

— INTERIORS BY VIDA —

2 BEDROOM

TYPE 1 MIRROR | BUILDING 3A

UNITS 108, 202, 208, 302, 308, 402, 408, 502, 508, 602, 608, 702,
708, 802, 808, 902, 908

| | | |
|--------------|--------------|------------|
| SUITE AREA | 951.31 SQFT | 88.38 SQM |
| BALCONY AREA | 151.88 SQFT | 14.11 SQM |
| TOTAL AREA | 1103.19 SQFT | 102.49 SQM |



KEY SECTION

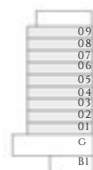

BUILDING 03A

KEY PLAN

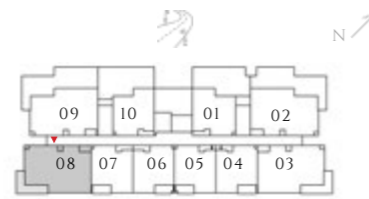

LEVEL 01

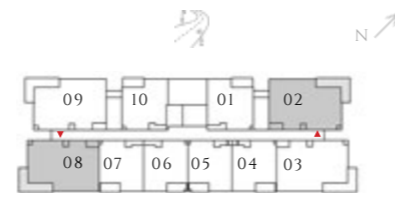

LEVEL 02-09

FLOOR PLAN 1. All dimensions are in imperial and metric, and measured from finish to finish excluding construction tolerances. 2. All materials, dimensions, and drawings are approximate only. 3. Information is subject to change without notice, at developer's absolute discretion. 4. Actual area may vary from the stated area. 5. Drawings not to scale. 6. All images used are for illustrative purposes only and do not represent the actual size, features, specifications, fittings, and furnishings. 7. The developer reserves the right to make revisions / alterations, at it's absolute discretion, without any liability whatsoever.

PARK LANE

DUBAI HILLS ESTATE

— INTERIORS BY VIDA —

2 BEDROOM

2BHK TYPE 1.1 | BUILDING 3A

UNITS 109

| | | |
|--------------|--------------|------------|
| SUITE AREA | 951.21 SQFT | 88.37 SQM |
| BALCONY AREA | 498.48 SQFT | 46.31 SQM |
| TOTAL AREA | 1449.68 SQFT | 134.68 SQM |



KEY SECTION

KEY PLAN



BUILDING 03A

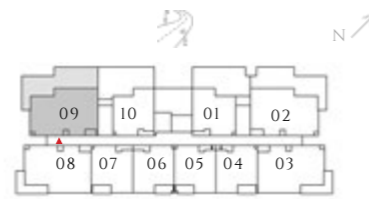

LEVEL 01

FLOOR PLAN 1. All dimensions are in imperial and metric, and measured from finish to finish excluding construction tolerances. 2. All materials, dimensions, and drawings are approximate only. 3. Information is subject to change without notice, at developer's absolute discretion. 4. Actual area may vary from the stated area. 5. Drawings not to scale. 6. All images used are for illustrative purposes only and do not represent the actual size, features, specifications, fittings, and furnishings. 7. The developer reserves the right to make revisions / alterations, at it's absolute discretion, without any liability whatsoever.

PARK LANE

DUBAI HILLS ESTATE

— INTERIORS BY VIDA —

2 BEDROOM

2BHK TYPE 1.1 MIRROR | BUILDING 3A

UNITS 102

| | | |
|--------------|--------------|------------|
| SUITE AREA | 951.21 SQFT | 88.37 SQM |
| BALCONY AREA | 482.12 SQFT | 44.79 SQM |
| TOTAL AREA | 1433.32 SQFT | 133.16 SQM |



KEY SECTION



BUILDING 03A

KEY PLAN

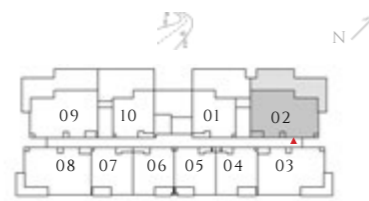

LEVEL 01

FLOOR PLAN 1. All dimensions are in imperial and metric, and measured from finish to finish excluding construction tolerances. 2. All materials, dimensions, and drawings are approximate only. 3. Information is subject to change without notice, at developer's absolute discretion. 4. Actual area may vary from the stated area. 5. Drawings not to scale. 6. All images used are for illustrative purposes only and do not represent the actual size, features, specifications, fittings, and furnishings. 7. The developer reserves the right to make revisions / alterations, at it's absolute discretion, without any liability whatsoever.